

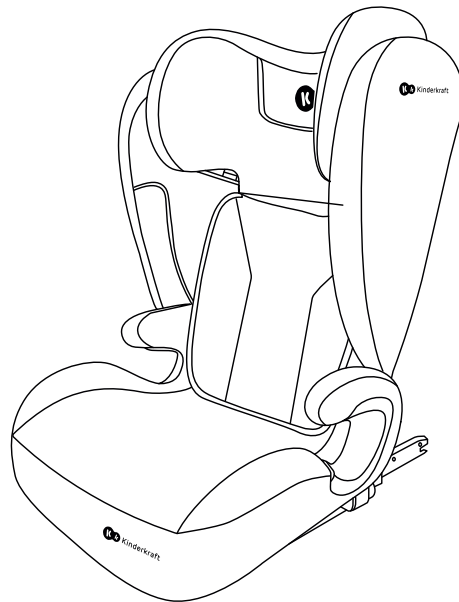

JUNIOR FIX 2

i-Size

Manual



MODEL: JUNIOR FIX 2 i-Size / JUNIOR FIX 2 PRO i-Size / JUNIOR FIX 2 PLUS i-Size
ECE R129.03 v.1.1

NOTE! Product graphics serve an illustrative function!

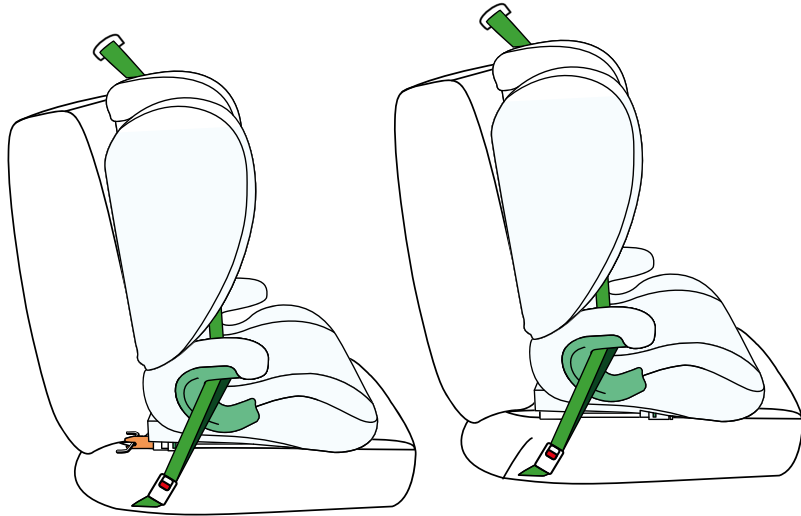

1.0 Usage

The car seat has been designed, tested and approved for use in accordance with the requirements of UN/ECE Regulation No. 129 concerning the approval of child restraint systems (UN/ECE R129/03).

The Junior Fix 2 i-Size car seat is designed to transport children with a height of 100-150 cm forward-facing.

The car seat can be installed in the car in the places indicated by the manufacturer in the vehicle manual. It is required to read the vehicle manufacturer's operating instructions.

To ensure proper installation, please refer to the table on the next page.

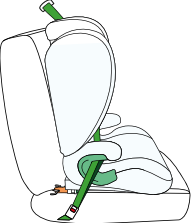
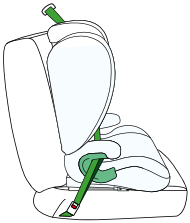
Hight of the child	Car seat setting	Car seat mounting
100-150cm		ISOFIX + three-point car seat belt
		Three-point car seat belt

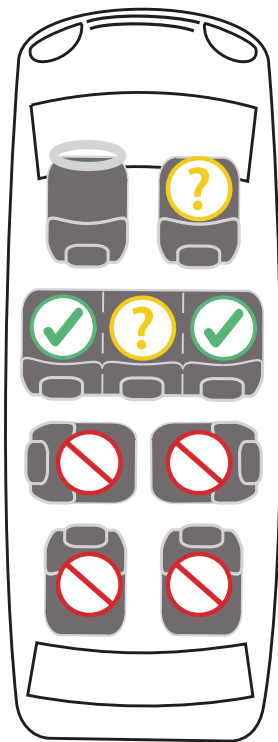

2.0 Safety instructions

Please take a few minutes to read this instruction manual in order to ensure the proper safety of your child.



- The car seat **MUST NOT** be installed on the vehicle seats mounted backwards or sideways.



- The car seat **MUST NOT** be placed on the vehicle seats with an active front air-bag.
- The car seat can only be installed on the vehicle seat with a three-point car seat belt.



- It is recommended to install the car seat on the vehicle back seats only.



!WARNINGS!

Please refer to your vehicle operating manual for information on the suitability of the vehicle seat for use with a car seat.

- ! Remember - the safety harness holding the child should be adjusted to the child's body shape and not twisted. For this reason, the child should not wear thick clothes under the safety harness.
- ! The waist part of the safety harness must run as low as possible across your child's pelvis to ensure optimum effect in the event of an accident.
- ! The car seat should be replaced when it has been subjected to violent stresses during a traffic accident.
- ! DO NOT make any modifications to the car seat or use it with the components from other manufacturers.
- ! Protect the car seat from direct sunlight, otherwise your child may be burnt by its heated parts. Protect your child and the car seat from sunlight.

- ! NEVER leave your child unattended in the car seat.
- ! Make sure that the luggage and other objects are adequately secured, in particular on the rear parcel shelf, as they can cause injuries in the event of a collision.
- ! The car seat cannot be used without the cover.
- ! DO NOT use replacement covers, other than those recommended by the manufacturer, as the cover is an integral part of the safety system of the car seat.
- ! DO NOT use any other attachment points than those described in the instruction manual and marked on the car seat.
- ! All hard elements and plastic parts of the car seat must be placed and installed in a way preventing them from being trapped by the sliding seat or vehicle doors under normal vehicle operating conditions.
- ! Do not use the car seat if its parts are damaged or loose.
- ! In the event of an emergency, it is important to quickly unfasten the car seat belts. This means that the release button of the safety harness is not fully secured; make sure your child does not play with the safety harness.

! Set a good example for your child and always fasten your car seat belt. An adult who is not fastened with a car seat belt can also pose a threat to a child.

! Make sure that the car seat is correctly secured before each journey in the car.

! The car seat must be secured at all times, even when not in use. The car seat that is not fastened can injure the passengers even during emergency braking.

! Regularly check the technical condition of the car seat, pay special attention to the fixing points, seams and adjusting parts. It is important to ensure that all mechanical elements are fully operational. Never grease or oil parts of the car seat.

! On some vehicle seats made of delicate materials, the use of car seats may leave marks and/or discolouration. In order to prevent it, you can place a blanket, towel or similar product under the car seat.

! DO NOT make any modifications to the car seat or use it with components from other manufacturers. Failure to install the seat in accordance with the manufacturer's instructions may lead to danger to life and health.

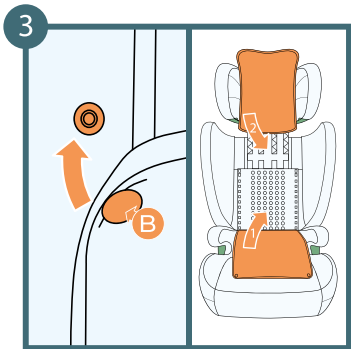
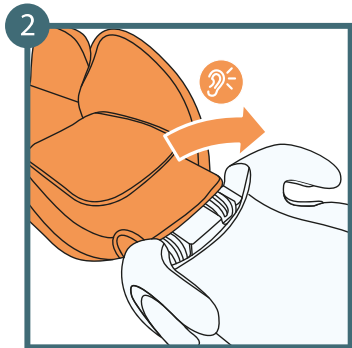
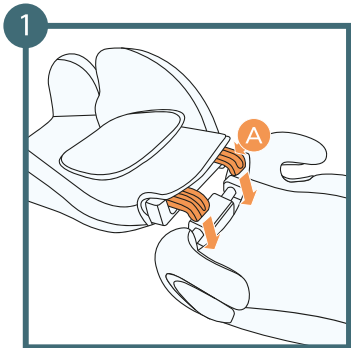

A: Backrest latches
B: Fasteners

3.0 Installing the car seat backrest

1. Place the backrest behind the seat and hook the bottom of the backrest onto the seat.
2. Adjust the backrest until it locks in the vertical position. You will hear a characteristic "click" sound.
3. Cover the inside of the car seat by fastening the fasteners on the backrest



Note! When rotating the backrest, check whether there are any obstacles in the area of the connector between the backrest and the seat.

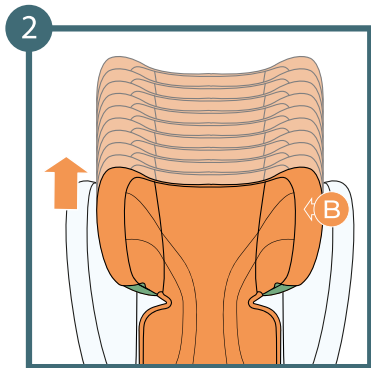
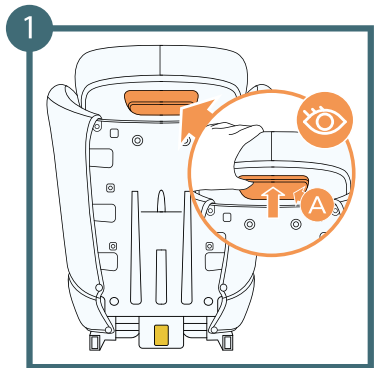

- A:** Headrest height adjustment lever
- B:** Headrest

4.0 Securing the child in the car seat

4.1 Headrest height adjustment

1. Grasp the headrest adjustment lever located on the back of the headrest and pull it gently upwards
2. Adjust the headrest by selecting one of ten options and when the height is adjusted, release the adjustment lever.



IMPORTANT! Make sure the car seat headrest is locked in place.

4.2 Correct headrest adjustment

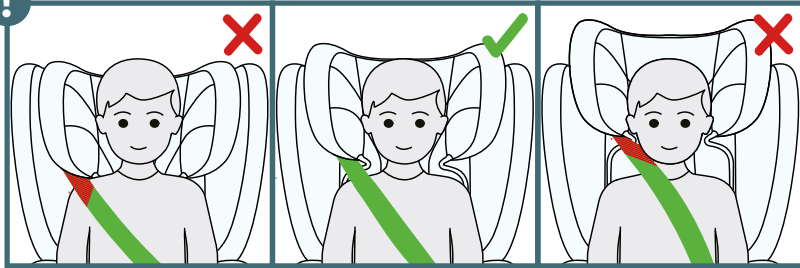

Verify whether the safety harness fits the child's body properly; if not, adjust the headrest height



When adjusting the headrest, make sure that the shoulder safety harness passes between the child's shoulder and neck (through the middle of the collarbone). The harness cannot press against the child's neck or slip off the shoulder.

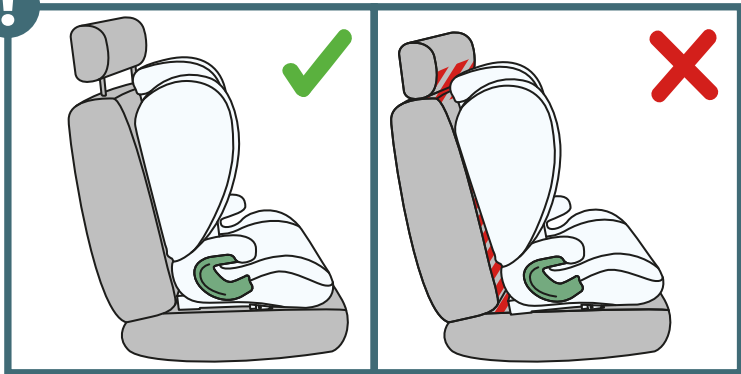

4.3 Adjusting the backrest

The backrest of the car seat is movable, thanks to which it is possible to adjust it accurately to the plane of the vehicle seat.



Adjust the position of the car seat backrest, until it is snug against the vehicle seat.



Caution: remove or adjust the headrest of the vehicle seat to make the car seat fit snugly against the backrest of the vehicle seat.

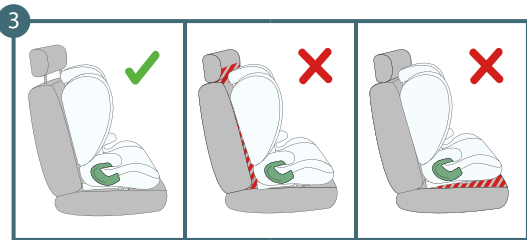
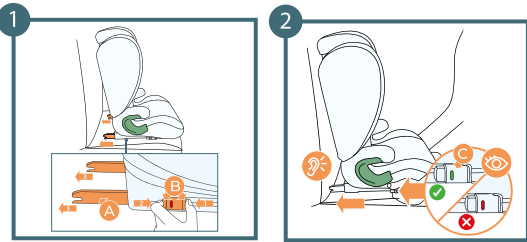

- A: ISOFIX latch**
- B: ISOFIX release button**
- C: ISOFIX button indicator**

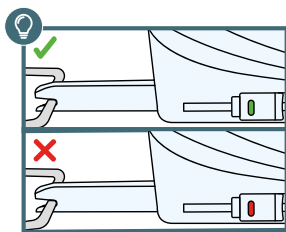

5.0 Installation in the vehicle

5.1 Installation using ISOFIX connectors

1. Press the ISOFIX latch release buttons and slide them out as far as possible.
2. Grasp the car seat with both hands and insert both latches into the places of installation on the vehicle seat. When you hear a "click" of each of the ISOFIX latches, push the seat of the car seat against the backrest of the vehicle seat, exerting firm even pressure on both sides.
3. Make sure that the backrest of the car seat rests flat against the backrest of the vehicle seat



NOTE! The ISOFIX connectors are properly attached only when both button indicators are completely green



Pay attention to the audible clicking sound of the ISOFIX connectors and grasp the car seat to check whether it is securely installed without any play. If it moves and the ISOFIX latches come out, repeat the previous steps.

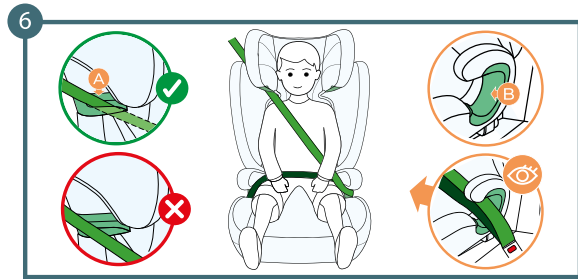
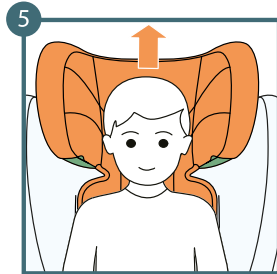
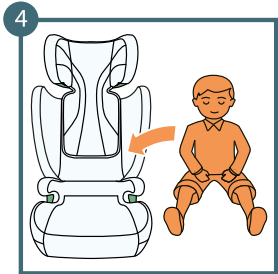

- A: Shoulder belt guide**
- B: Waist belt guide**

4. Place your child in the car seat
5. Adjust the headrest to the child's height.
6. Pass the vehicle seat belt through the car seat shoulder guide and waist guides, and then fasten it. You should hear a characteristic "click". Pay attention to the correct positioning of the belt in the guides (waist and shoulder guides).

7

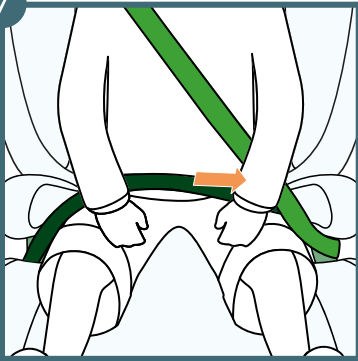

8

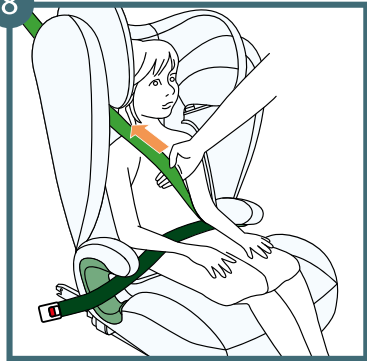

7. Pull the waist section of the belt towards the buckle and then the shoulder section towards the belt retractor, eliminating any slack.
8. Pull the shoulder belt so that it sits flat against your child's body

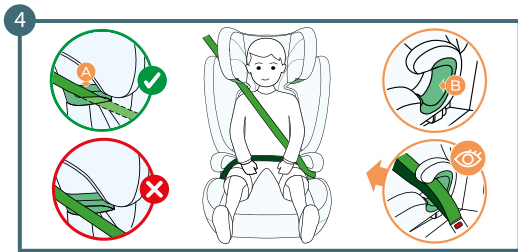
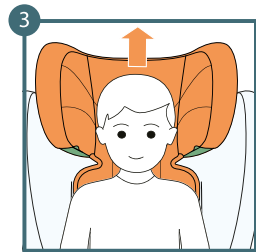
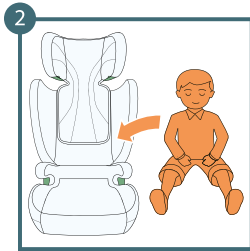
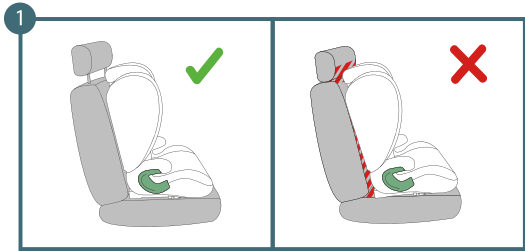

A: Shoulder belt guide
B: Waist belt guide

5.2 Installation using the vehicle three-point seat belt.

1. Make sure that the backrest of the car seat rests flat against the backrest of the vehicle seat.
2. Place your child in the car seat
3. Adjust the headrest to the child's height.
4. Pass the car seat belt through the car seat shoulder guide and waist guides, and then fasten it. You should hear a characteristic "click". Pay attention to the correct positioning of the belt in the guides (waist and shoulder guides).

5

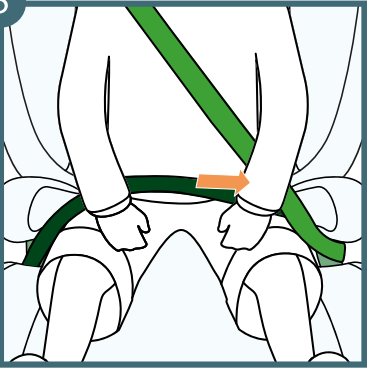

6

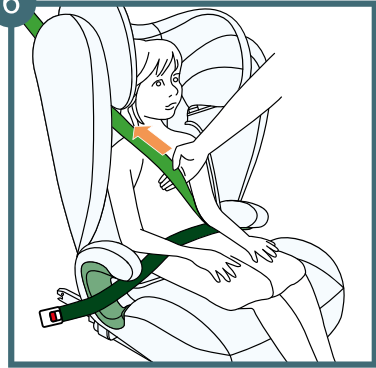

- 5. Pull the waist section of the belt towards the buckle and then the shoulder section towards the belt retractor, eliminating any slack.
- 6. Pull the shoulder belt so that it sits flat against your child's body

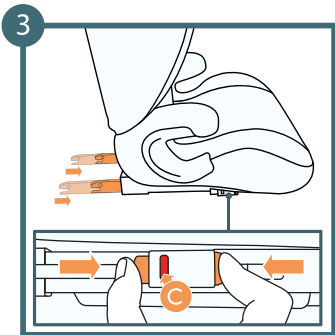
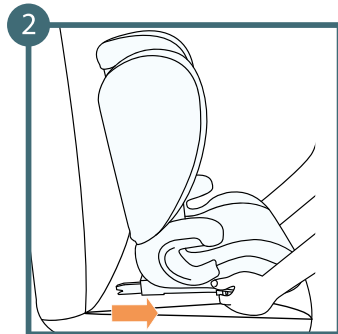
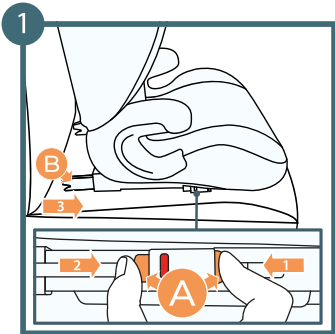

- A:** Shoulder belt guide
- B:** Waist belt guide
- C:** ISOFIX button indicator

6.0 Removing the car seat (ISOFIX installation system)

1. Press the ISOFIX release buttons on both ISOFIX latches simultaneously.
2. When the latches are released and the ISOFIX button indicators turn red, slide the car seat out of the ISOFIX guides.
3. Slide the ISOFIX latches back into the car seat base.

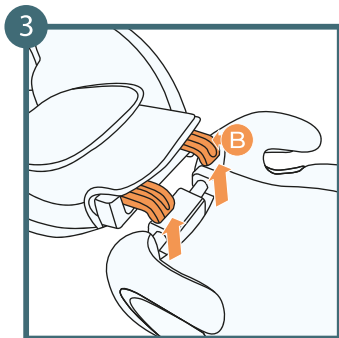
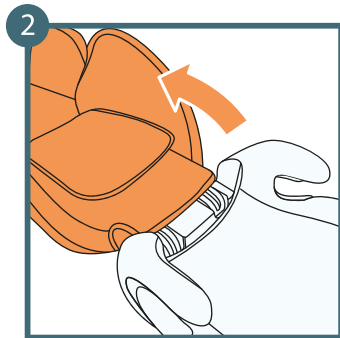
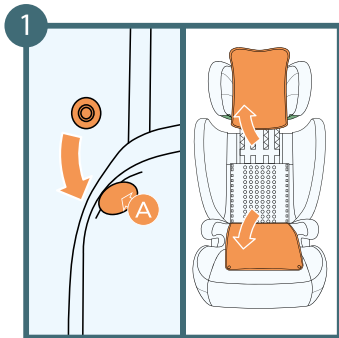

A: ISOFIX release button
B: ISOFIX latch

7.0 Removing the car seat backrest for storage

1. Uncover the inside of the car seat by unfastening the fasteners located on the backrest.
2. Push the backrest so that it lies flat.
3. Detach the backrest by pulling it out from the latches

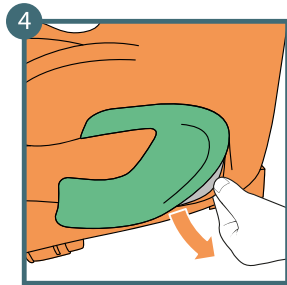
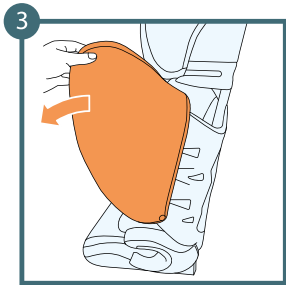
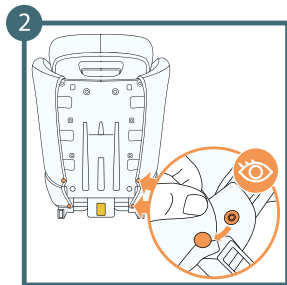
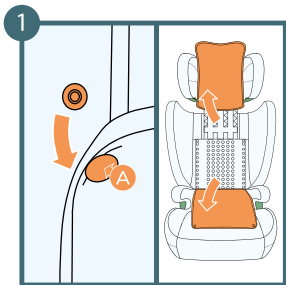

- A: Fasteners**
- B: Backrest latches**

8.0 Removing the cover

1. To make it easier to remove the cover, raise the headrest to the highest position. Uncover the car seat cover by replacing the material from the backrest to the headrest, and then unfasten the fasteners located on the edges of the fabric of the inner part of the car seat backrest.
2. Unfasten all the fasteners on the edges of the cover on the back of the car seat (on both sides), on the backrest and the seat.
3. Pull the fabric off the sides of the car seat.
4. Gently pulling on the material, slide it off the waist safety harness guides on both sides of the car seat.

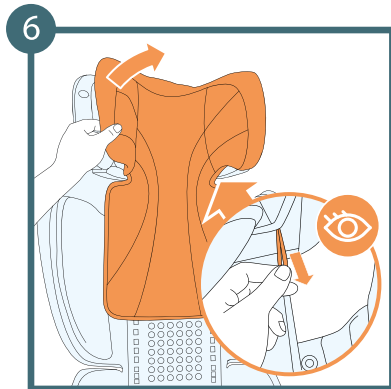
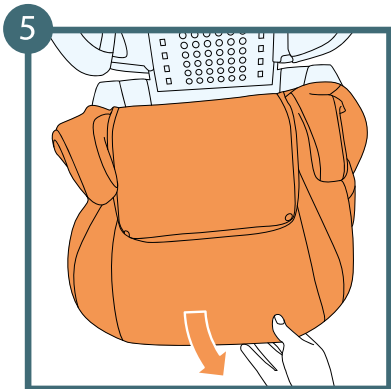

5. Pull the material towards you to slide it off the seat.

6. Remove the fabric from the headrest starting from its sides.

8.1 Installing the cover

To put the cover back on - just reverse the above sequence of actions.

Align the cover with the attachment points on the car seat. Start by installing the cover on the shell of the car seat and finally on the headrest part.

9.0 Cleaning

NOTE! The car seat must not be used without the cover.

- The cover is removable and washable with a mild powder and using a program for delicate fabrics (30°C).
- Follow the washing instructions on the cover information label. The colours may fade if it is washed at the temperature above 30°C. The cover should not be centrifuged or dried in a tumble dryer (which may lead to separation of the material layers).
- Prolonged sun exposure of the cover is prohibited.
- Plastic parts can be cleaned with soap and water.
- Do not use aggressive cleaning agents (such as bleach/stain removers).

Full text of Warranty Terms and Conditions is available on the website WWW.KINDERKRAFT.COM



(AR) ضمان مصلحة عملائنا - نحن في خدمتكم! إذا كانت لديكم أي مشكلة مع المنتج الذي حصلتم عليه، فيجربى الاتصال بنا بالطريقة التي تفضلونها!

(CS) V zájmu péče o naše klienty - jsme rádi k dispozici! Pokud jste se setkali s nějakým problémem v souvislosti s obdrženým výrobkem, kontaktujte nás způsobem, který vám nejvíce vyhovuje!

(DE) In Sorge für unsere Kunden - stehen wir gerne zu Ihrer Verfügung! Wenn Sie auf ein Problem mit dem erhaltenen Produkt treffen, treten Sie bitte mit uns in Kontakt in der bequemsten Weise für Sie!

(EN) In the interests of our Clients - we are at your disposal! If you have a problem with the product you received, contact us in the most convenient way for you!

(ES) ¡Por el bien de nuestros clientes, estamos a su disposición! ¡Si tiene cualquier problema con el producto recibido, póngase en contacto con nosotros de forma más cómoda para usted!

(FR) Dans l'intérêt de nos clients - nous sommes à votre disposition! Si vous avez un problème avec le produit que vous avez reçu, contactez-nous de la manière la plus pratique pour vous!

(HU) Bármikor állunk az ügyfeleink rendelkezésére! Ha az átvett termékkel kapcsolatban valamilyen problémába ütközött, az Onnek legmegfelelőbb módon vegye fel velünk a kapcsolatot!

(IT) Prendersi cura dei nostri Clienti - siamo alla Vostra disposizione! Se hai incontrato un problema con il prodotto che hai ricevuto. Contattaci nel modo piu conveniente per te!

(NL) In het belang van onze klanten - staan wij ter beschikking! Als u een probleem met het ontvangen product tegenkomt, neemt contact met ons op via de manier die u het makkelijkste vindt!

(PL) W trosce o naszych Klientów - jesteśmy do dyspozycji! Jeśli napotkałeś problem dotyczący otrzymanego produktu, skontaktuj się z nami w najbardziej dogodny dla Ciebie sposób!

(PT) Para o conforto dos nossos Clientes - estamos sempre à sua disposição! Se tiver qualquer problema com o nosso produto, entre em contacto conosco de modo mais confortável para si!

(RO) In interesul clienților noștri - suntem la dispoziția dumneavoastră! Dacă aveți o problema cu produsul pe care l-ați primit, contactați-ne în modul cel mai convenabil pentru dvs.!

(RU) заботясь о наших клиентах, мы находимся в вашем распоряжении. Если вы столкнулись с проблемой, связанной с полученным продуктом, свяжитесь с нами наиболее удобным для вас способом!

(SK) Náš zákazník je pre nás dôležitý - sme vám k dispozícii! Ak máte akýkoľvek problém súvisiaci s doručeným produktom, kontaktujte nás spôsobom, ktorý vám najviac vyhovuje!

(SV) I våra kundens intresse - vi står till ditt förfogande! Om du har problem med den produkt du fick, kontakta oss på det mest praktiska sättet för dig!

International contact:

help@kinderkraft.com

(0044) 7441 476675



kinderkraftofficial



kinderkraft



kinderkraftofficial

منتج/ВЫРОБЦЕ/HERSTELLER/MANUFACTURER/FABRICANTE/FABRICANT/
GYARTÓ/FABBRICANTE/FABRIKANT/PRODUCENT/FABRICANTE/PRODUCĂTOR/
ПРОИЗВОДИТЕЛЬ/ВЫРОВА/ТИЛЛВЕРКАРЕ:

4Kraft Sp. z o.o. ul. Tatrzańska 1/5
60-413 Poznań, Poland